

# Re Discussion,

corn brought by landown  
would make no difference.

The total amount of corn would not  
be affected, there would be  
two tons less gold production.

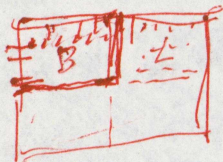

Price:  $\frac{x \text{ units}^4}{\text{unit}}$  is the gold value of a man  
there for  $N_1$  or  $N_2$  men  
produce  $N_1$  or  $N_2$   $\frac{x \text{ units}^4}{\text{unit}}$